

# GENERAL SPECIFICATION OF HLS12-50

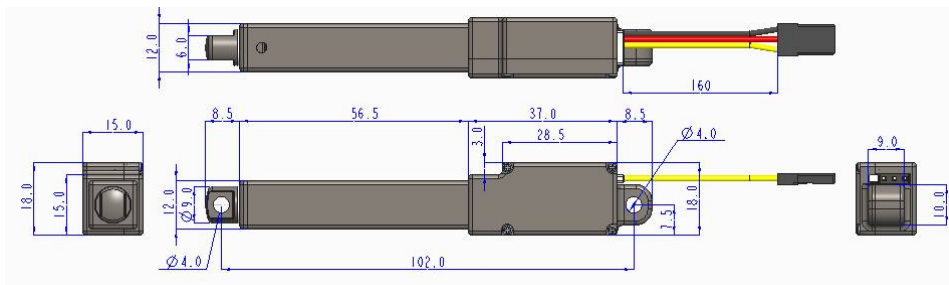

UPDATE : 2019-04-22

<b>Control System</b>	Pulse Width Modulation(PWM) (1000us ~ 2000us)		
<b>Operating Voltage Range</b>	4.8V ~7.4V		
<b>Motor Type</b>	DC Cored(carbon brush)		
<b>Controller(MCU)</b>	32Bits		
<b>Gear Ratio</b>	100:1		
<b>Stroke Option</b>	30mm		
<b>Max Side Load(Extended)</b>	30N		
<b>Voltage</b>	At 4.8V	At 6.0V	At 7.4V
<b>No Load Speed</b>	10mm/s	13mm/s	15mm/s
<b>Idle current</b>	45mA	50mA	55mA
<b>No Load Running Current</b>	75mA	80mA	90mA
<b>Load Speed</b>	1.7Kg(17N)	8mm/s	11mm/s
	3.1Kg(31N)	4mm/s	7mm/s
	4.2Kg(42N)	3mm/s	5mm/s
<b>Load Running Current</b>	1.7Kg(17N)	200mA	210mA
	3.1Kg(31N)	290mA	300mA
	4.2Kg(42N)	390mA	410mA
<b>Stall Current</b>	500mA	600mA	700mA
<b>Max Static Force</b>	200N		
<b>Max Linear force</b>	4.2Kg(42N)		
<b>Operating Temperature Range</b>	-10°C ~ +50°C		
<b>Vibrations at No Load</b>	MIL-STD-810G 514.6C-VII		
<b>Storage Temperature Range</b>	-30°C ~ +80°C (-31°F ~ +176°F)		
<b>Connector Wire Length</b>	160mm(6.29in)		
<b>Outline Dimensions</b>	102.0 x 15.0 x 18.0mm(4.02 x 0.60 x 0.70in)		
<b>Weight</b>	40.0g(1.41oz)		
<b>Ball Bearing</b>	MF104 (open type)		
<b>Case Material</b>	Engineering Plastic & Hardened Metal		
<b>Gear Material</b>	Metal		
<b>Repeatability</b>	±0.3mm		



UNIT : mm

HITEC RCD KOREA INC.